

NOTES:

1. CONTOURS GENERATED USING THE 2018 LIDAR DERIVED DATA SET REPRESENTING BARE-EARTH TERRAIN FROM LAND INFORMATION ONTARIO.
2. TOPOGRAPHIC SURVEY DATA WAS COLLECTED AND PROVIDED BY DIETRICH ENGINEERING LIMITED.

BENCHMARK DESCRIPTIONS

BENCHMARK No. 1 ELEV.=217.26
NAIL IN NORTHWEST FACE OF HYDRO POLE.

LEGEND

- LOT/CONCESSION LINE
- PROPERTY LINE
- FUTURE PROPERTY LINE
- URBAN BOUNDARY
- MAJOR WATERSHED BOUNDARY
- MINOR WATERSHED BOUNDARY
- CONSTRUCTION/MAINTENANCE ACCESS
- BENCHMARK LOCATION
- B.M. 1
123.45 BENCHMARK No.
123.45 BENCHMARK ELEVATION
- JOHN & JANE SMITH LANDOWNER NAME(S)
12-345 ASSESSMENT ROLL No. (ABBREVIATED)
(12.3 Ha.) AREA WITHIN WATERSHED
- EXISTING FEATURES:
 - ← DRAIN NAME (with crossing symbol) OPEN DRAIN WITH CROSSING AND FLOW DIRECTION
 - ← DRAIN NAME (with catch basin symbol) CLOSED DRAIN WITH CATCH BASIN, MANHOLE AND FLOW DIRECTION
 - OVERLAND FLOW PATH
- PROPOSED FEATURES:
 - ← DRAIN NAME (with crossing symbol) OPEN DRAIN WITH CROSSING AND FLOW DIRECTION
 - ← DRAIN NAME (with catch basin symbol) CLOSED DRAIN WITH CATCH BASIN, MANHOLE AND FLOW DIRECTION

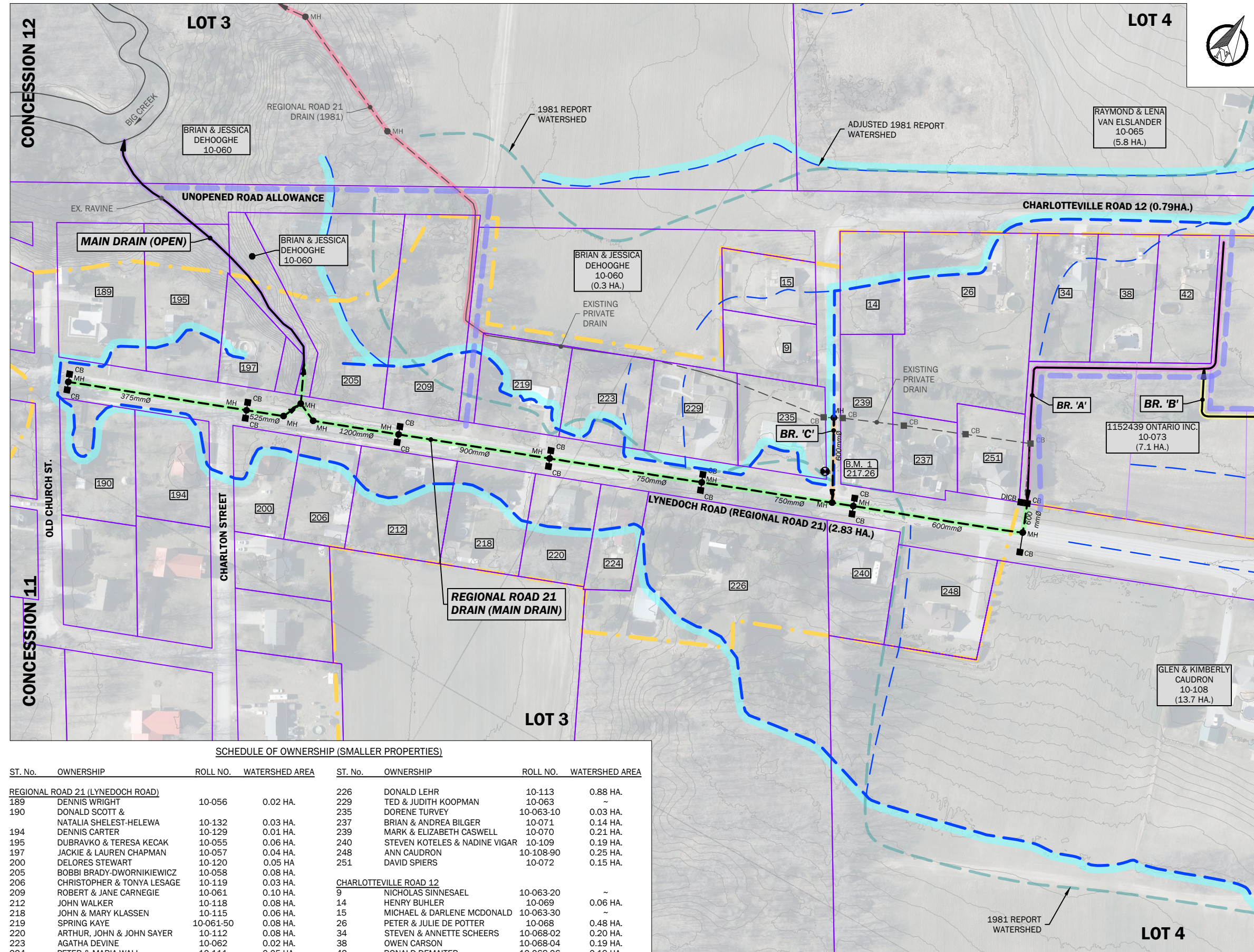

SCHEDULE OF OWNERSHIP (SMALLER PROPERTIES)

ST. No.	OWNERSHIP	ROLL NO.	WATERSHED AREA	ST. No.	OWNERSHIP	ROLL NO.	WATERSHED AREA
REGIONAL ROAD 21 (LYNEDOCH ROAD)							
189	DENNIS WRIGHT	10-056	0.02 HA.	226	DONALD LEHR	10-113	0.88 HA.
190	DONALD SCOTT & NATALIA SHELEST-HELEWA	10-132	0.03 HA.	229	TED & JUDITH KOOPMAN	10-063	~
194	DENNIS CARTER	10-129	0.01 HA.	235	DORENE TURVEY	10-063-10	0.03 HA.
195	DUBRAVKO & TERESA KECAK	10-055	0.06 HA.	237	BRIAN & ANDREA BILGER	10-071	0.14 HA.
197	JACKIE & LAUREN CHAPMAN	10-057	0.04 HA.	239	MARK & ELIZABETH CASWELL	10-070	0.21 HA.
200	DELORES STEWART	10-120	0.05 HA.	240	STEVEN KOTELES & NADINE VIGAR	10-109	0.19 HA.
205	BOBBI BRADY-DWORNIKIEWICZ	10-058	0.08 HA.	248	ANN CAUDRON	10-108-90	0.25 HA.
206	CHRISTOPHER & TONYA LESAGE	10-119	0.03 HA.	251	DAVID SPIERS	10-072	0.15 HA.
209	ROBERT & JANE CARNEGIE	10-061	0.10 HA.	CHARLOTTEVILLE ROAD 12			
212	JOHN WALKER	10-118	0.08 HA.	9	NICHOLAS SINNESAEI	10-063-20	~
218	JOHN & MARY KLASSEN	10-115	0.06 HA.	14	HENRY BUHLER	10-069	0.06 HA.
219	SPRING KAYE	10-061-50	0.08 HA.	15	MICHAEL & DARLENE MCDONALD	10-063-30	~
220	ARTHUR, JOHN & JOHN SAYER	10-112	0.08 HA.	26	PETER & JULIE DE POTTER	10-068	0.48 HA.
223	AGATHA DEVINE	10-062	0.02 HA.	34	STEVEN & ANNETTE SCHEERS	10-068-02	0.20 HA.
224	PETER & MARIA WALL	10-111	0.05 HA.	38	OWEN CARSON	10-068-04	0.19 HA.
				42	RONALD DEMAITER	10-068-06	0.19 HA.

PLAN SCALE

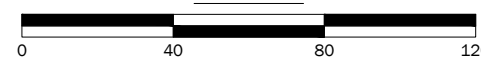

8	ISSUED FOR CONSTRUCTION	23-07-04
7	ISSUED FOR TENDER	23-04-18
6	REPORT SUBMISSION	22-12-21
5	DRAFT REPORT SUBMISSION	SEP. 2022
4	INFORMATION MEETING	22-03-09
3	COUNTY MEETING	22-01-18
2	COUNTY MEETING	21-08-12
1	COUNTY SUBMISSION	21-05-11
No.	REVISION	DATE (YY-MM-DD)



DRAWN BY: R.U.	DESIGNED BY: S.B.	CHECKED BY: S.B.
DATE: 2023-04-18	REFERENCE No. NRFLK-001	DRAWING No. 2 OF 9

NOTES:

1. CONTOURS GENERATED USING THE 2018 LIDAR DERIVED DATA SET REPRESENTING BARE-EARTH TERRAIN FROM LAND INFORMATION ONTARIO.
2. TOPOGRAPHIC SURVEY DATA WAS COLLECTED AND PROVIDED BY DIETRICH ENGINEERING LIMITED.

BENCHMARK DESCRIPTIONS

BENCHMARK No. 1 ELEV.=217.26
NAIL IN NORTHWEST FACE OF HYDRO POLE.

LEGEND

- LOT/CONCESSION LINE
- PROPERTY LINE
- FUTURE PROPERTY LINE
- URBAN BOUNDARY
- MAJOR WATERSHED BOUNDARY
- MINOR WATERSHED BOUNDARY
- FUTURE MAINTENANCE ACCESS
- BENCHMARK LOCATION
- B.M. 1 123.45 BENCHMARK No. BENCHMARK ELEVATION
- JOHN & JANE SMITH 12-345 (12.3 Ha.) LANDOWNER NAME(S) ASSESSMENT ROLL No. (ABBREVIATED) AREA WITHIN WATERSHED

EXISTING FEATURES:

- DRAIN NAME OPEN DRAIN WITH CROSSING AND FLOW DIRECTION
- DRAIN NAME CLOSED DRAIN WITH CATCH BASIN, MANHOLE AND FLOW DIRECTION
- OVERLAND FLOW PATH

PROPOSED FEATURES:

- DRAIN NAME OPEN DRAIN WITH CROSSING AND FLOW DIRECTION
- DRAIN NAME CLOSED DRAIN WITH CATCH BASIN, MANHOLE AND FLOW DIRECTION

8	ISSUED FOR CONSTRUCTION	23-07-04
7	ISSUED FOR TENDER	23-04-18
6	REPORT SUBMISSION	22-12-21
5	DRAFT REPORT SUBMISSION	SEP. 2022
4	INFORMATION MEETING	22-03-09
3	COUNTY MEETING	22-01-18
2	COUNTY MEETING	21-08-12
1	COUNTY SUBMISSION	21-05-11
No.	REVISION	DATE (YY-MM-DD)



DRAWN BY: R.U.	DESIGNED BY: S.B.	CHECKED BY: S.B.
DATE: 2023-04-18	REFERENCE No. NRFLK-001	DRAWING No. 3 OF 9

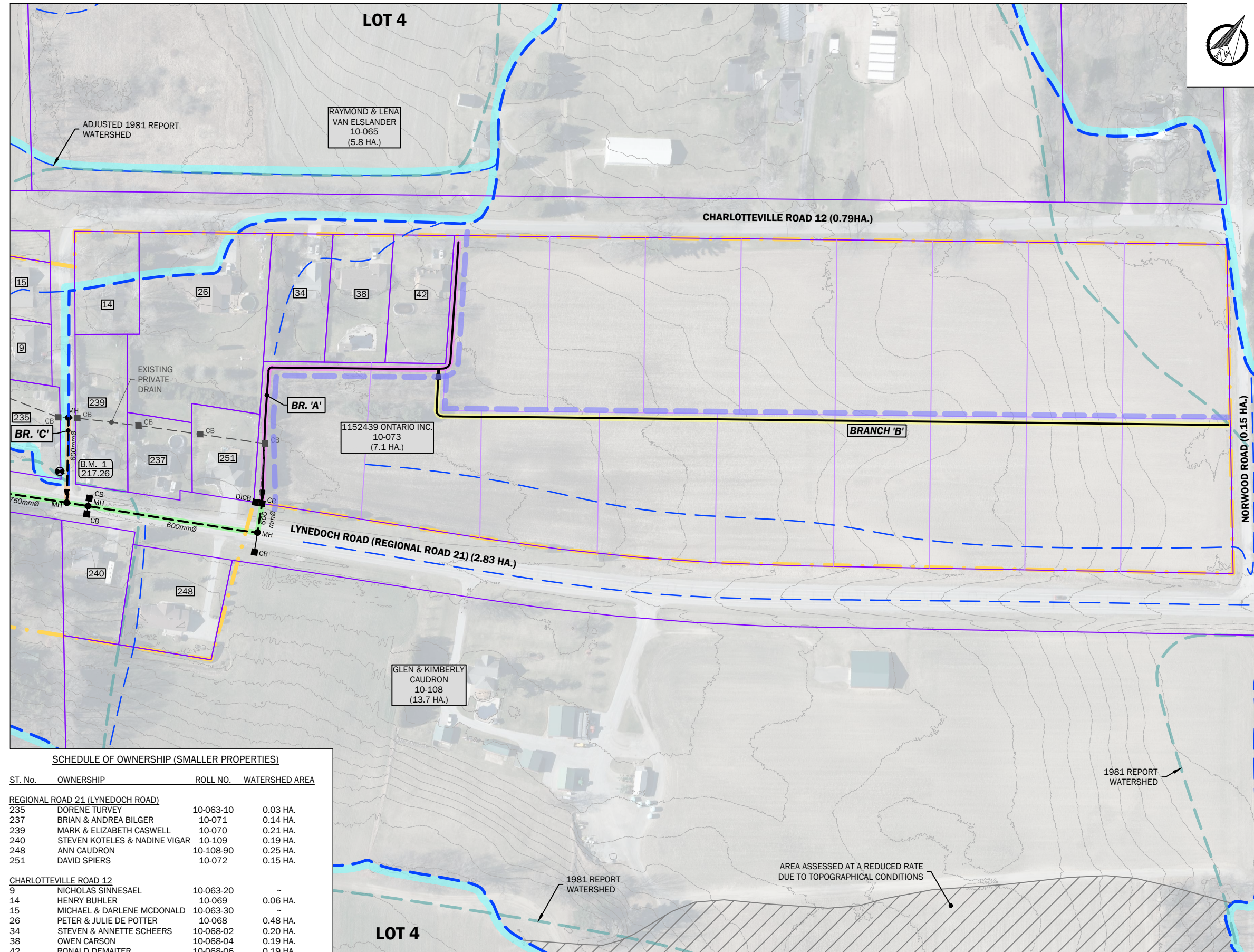

SCHEDULE OF OWNERSHIP (SMALLER PROPERTIES)

ST. No.	OWNERSHIP	ROLL NO.	WATERSHED AREA
REGIONAL ROAD 21 (LYNEDOCH ROAD)			
235	DORENE TURVEY	10-063-10	0.03 HA.
237	BRIAN & ANDREA BILGER	10-071	0.14 HA.
239	MARK & ELIZABETH CASWELL	10-070	0.21 HA.
240	STEVEN KOTELES & NADINE VIGAR	10-109	0.19 HA.
248	ANN CAUDRON	10-108-90	0.25 HA.
251	DAVID SPIERS	10-072	0.15 HA.
CHARLOTTEVILLE ROAD 12			
9	NICHOLAS SINNESAEI	10-063-20	~
14	HENRY BUHLER	10-069	0.06 HA.
15	MICHAEL & DARLENE MCDONALD	10-063-30	~
26	PETER & JULIE DE POTTER	10-068	0.48 HA.
34	STEVEN & ANNETTE SCHEERS	10-068-02	0.20 HA.
38	OWEN CARSON	10-068-04	0.19 HA.
42	RONALD DEMAITER	10-068-06	0.19 HA.

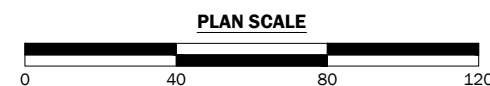

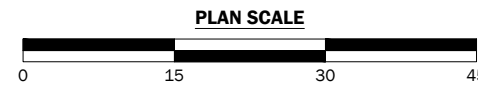
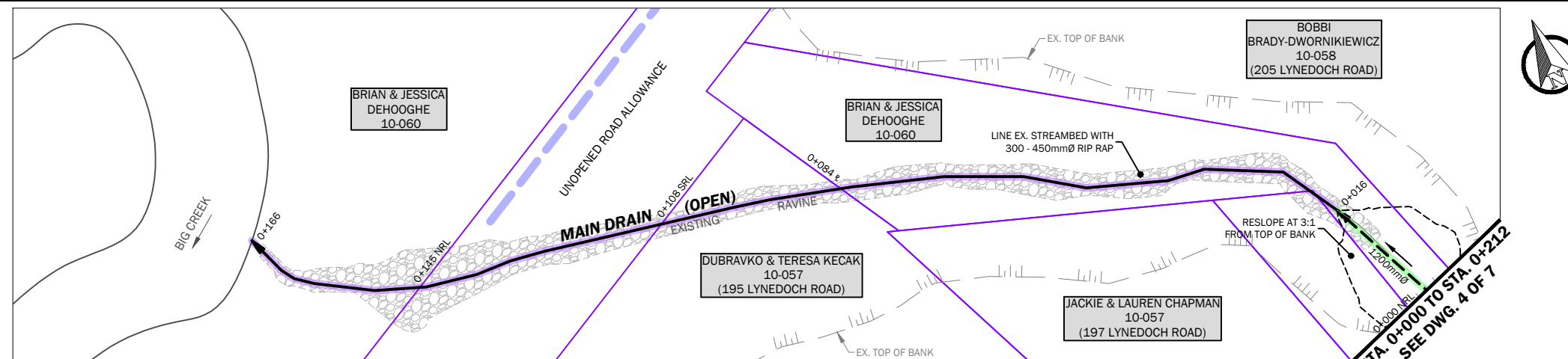

KEY PLAN

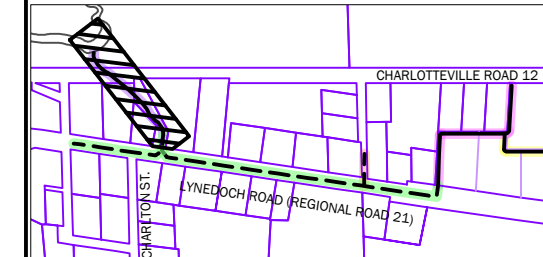

NOTES:

1. RAVINE CONSTRUCTION ACTIVITIES TO OCCUR IN DRY OR LOW FLOW CONDITIONS.
2. THE CONTRACTOR SHALL PLACE NECESSARY EROSION AND SEDIMENT CONTROL MEASURES.
3. THE CONTRACTOR SHALL MONITOR WEATHER FORECASTS AND CHECK / MAINTAIN EROSION AND SEDIMENT CONTROL MEASURES PRIOR TO PREDICTED RAINFALL EVENTS, AND AFTER ACTUAL RAINFALL EVENTS.

BENCHMARK DESCRIPTIONS

BENCHMARK No. 1 ELEV.=217.26
NAIL IN NORTHWEST FACE OF HYDRO POLE.

LEGEND

- LOT/CONCESSION LINE
- PROPERTY LINE
- FUTURE PROPERTY LINE
- CONSTRUCTION/MAINTENANCE ACCESS
- BENCHMARK LOCATION
- B.M. 1 (123.45) BENCHMARK No. BENCHMARK ELEVATION
- JOHN & JANE SMITH 12-345 (12.3 Ha.) LANDOWNER NAME(S) ASSESSMENT ROLL No. (ABBREVIATED) AREA WITHIN WATERSHED
- EXISTING FEATURES: DRAIN NAME OPEN DRAIN WITH CROSSING AND FLOW DIRECTION
- PROPOSED FEATURES: DRAIN NAME OPEN DRAIN WITH CROSSING AND FLOW DIRECTION
- DRAIN NAME CLOSED DRAIN WITH CATCH BASIN, MANHOLE AND FLOW DIRECTION

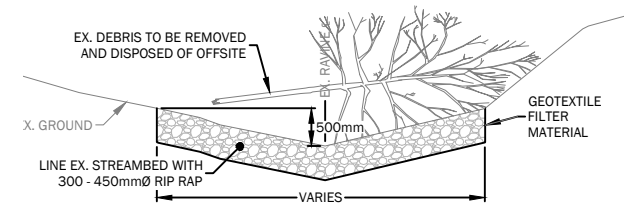

TYPICAL RAVINE IMPROVEMENT CROSS SECTION N.T.S.

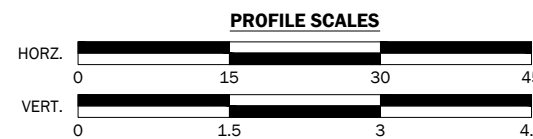
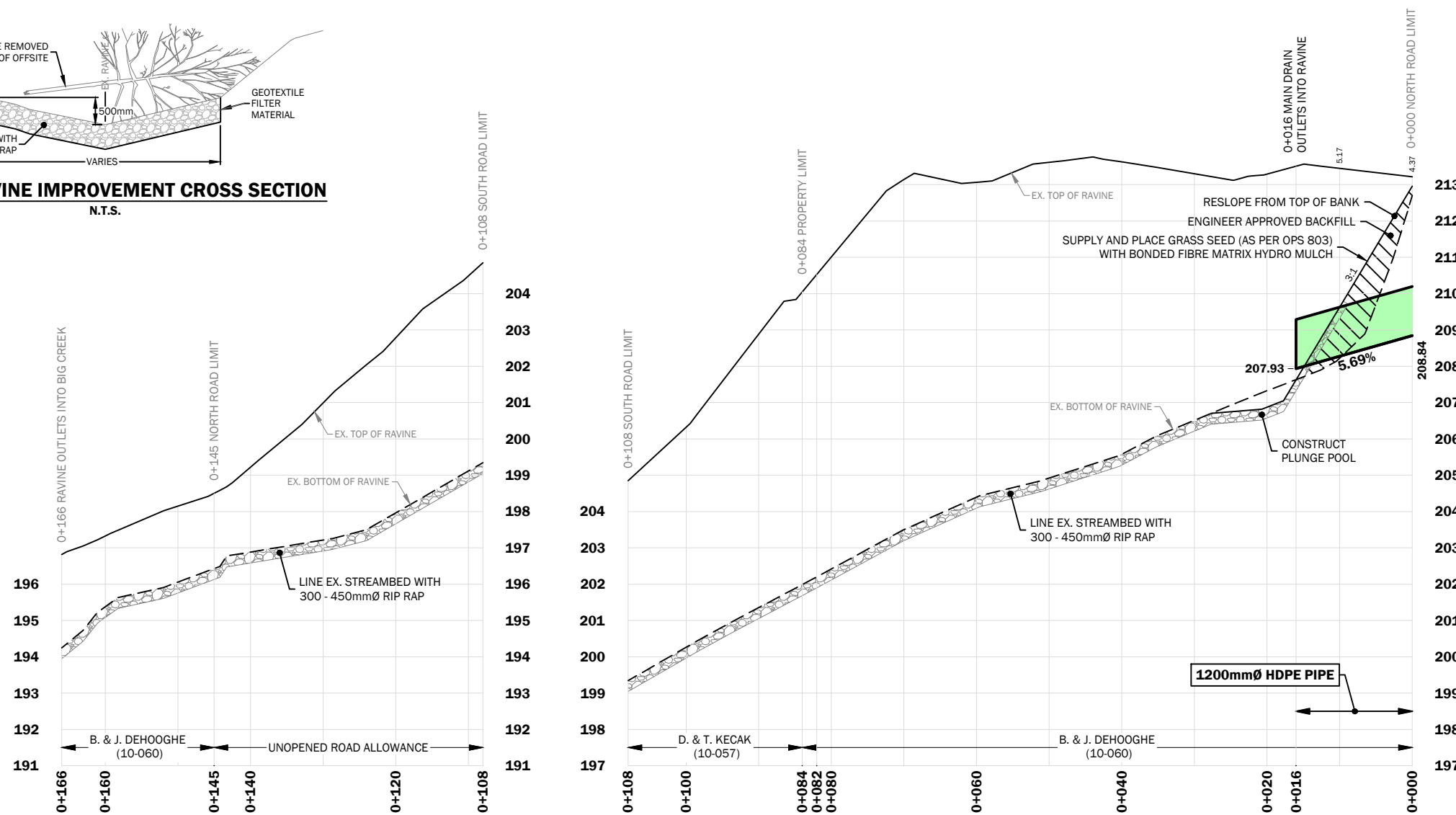

SCHEDULE OF PIPE MATERIALS

MATERIAL	DIAMETER (mm)	STATION RANGE	LENGTH (m)
1. HIGH DENSITY POLYETHYLENE PIPE	1200	0+000 - 0+166	16

8	ISSUED FOR CONSTRUCTION	23-07-04
7	ISSUED FOR TENDER	23-04-18
6	REPORT SUBMISSION	22-12-21
5	DRAFT REPORT SUBMISSION	SEP. 2022
4	INFORMATION MEETING	22-03-09
3	COUNTY MEETING	22-01-18
2	COUNTY MEETING	21-08-12
1	COUNTY SUBMISSION	21-05-11
No.	REVISION	DATE (YY-MM-DD)

KEY PLAN

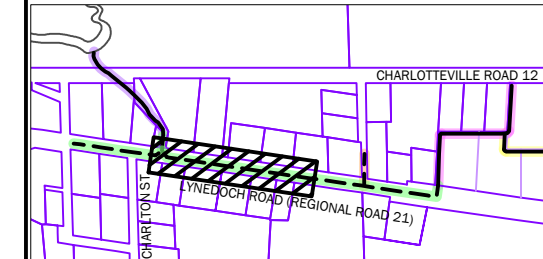

NOTES:

- TOPOGRAPHIC SURVEY DATA WAS COLLECTED AND PROVIDED BY DIETRICH ENGINEERING LIMITED.

BENCHMARK DESCRIPTIONS

BENCHMARK No. 1 ELEV.=217.26
NAIL IN NORTHWEST FACE OF HYDRO POLE.

LEGEND

- LOT/CONCESSION LINE
- PROPERTY LINE
- FUTURE PROPERTY LINE
- BENCHMARK LOCATION
- B.M. 1 123.45 BENCHMARK No.
- 123.45 BENCHMARK ELEVATION
- JOHN & JANE SMITH LANDOWNER NAME(S)
- 12-345 ASSESSMENT ROLL No. (ABBREVIATED)
- 12.3 Ha. AREA WITHIN WATERSHED
- EXISTING FEATURES:
 - STM STORM SEWER WITH CATCH BASIN
 - TEL TELEPHONE LINE
 - FO FIBER OPTIC LINE
 - GAS GAS LINE
 - O/H OVERHEAD UTILITY LINE
 - O.H.P. HYDRO POLE WITH GUY WIRE
 - TEL TELEPHONE PEDESTAL
- PROPOSED FEATURES:
 - DRAIN NAME CLOSED DRAIN WITH CATCH BASIN, MANHOLE AND FLOW DIRECTION

8	ISSUED FOR CONSTRUCTION	23-07-04
7	ISSUED FOR TENDER	23-04-18
6	REPORT SUBMISSION	22-12-21
5	DRAFT REPORT SUBMISSION	SEP. 2022
4	INFORMATION MEETING	22-03-09
3	COUNTY MEETING	22-01-18
2	COUNTY MEETING	21-08-12
1	COUNTY SUBMISSION	21-05-11
No.	REVISION	DATE (YY-MM-DD)



DRAWN BY: R.U.	DESIGNED BY: S.B.	CHECKED BY: S.B.
DATE: 2023-04-18	REFERENCE No. NRFLK-001	DRAWING No. 5 OF 9

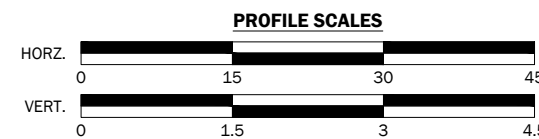
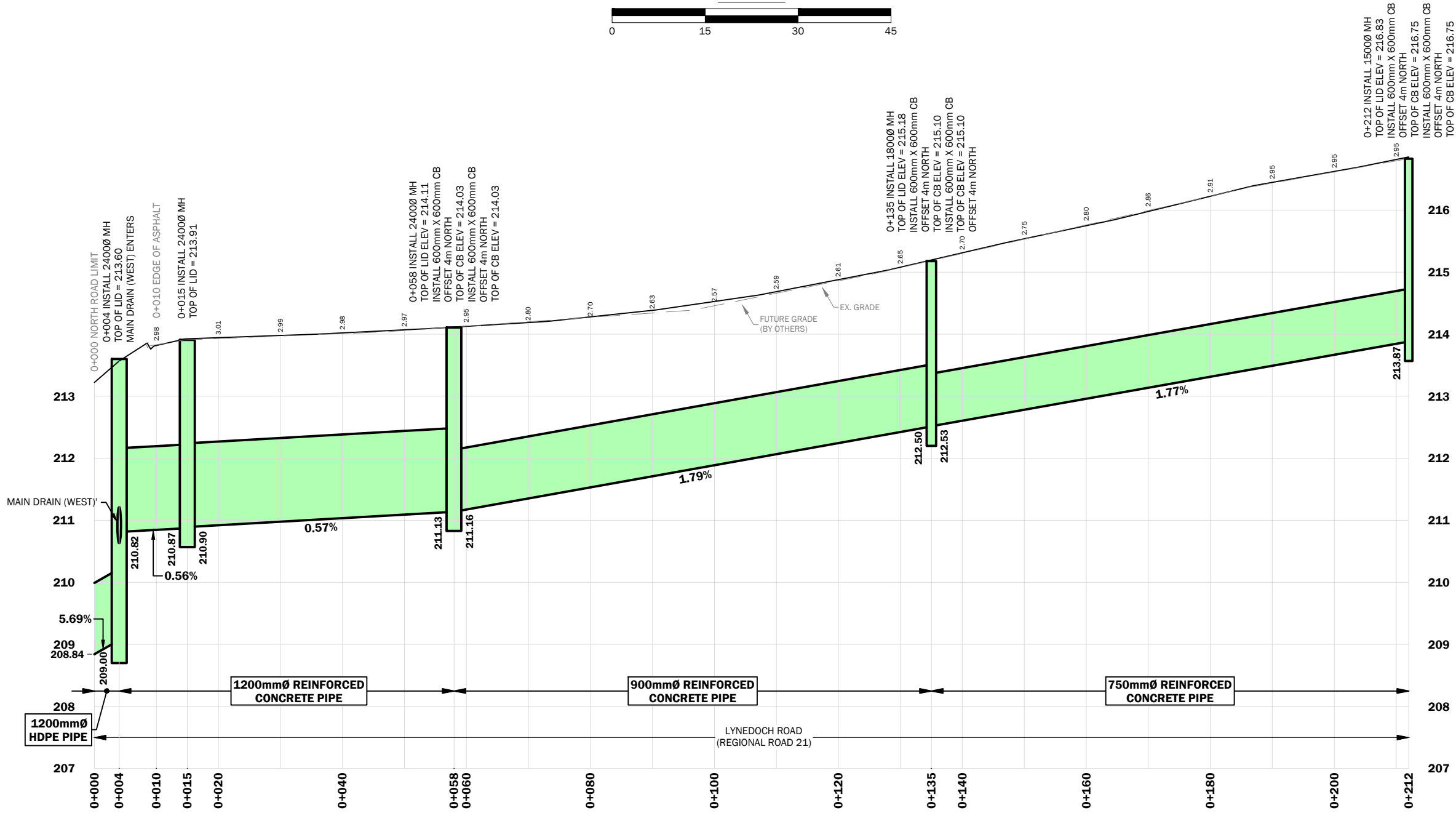
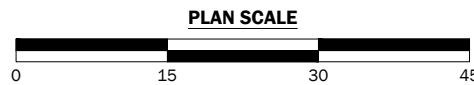
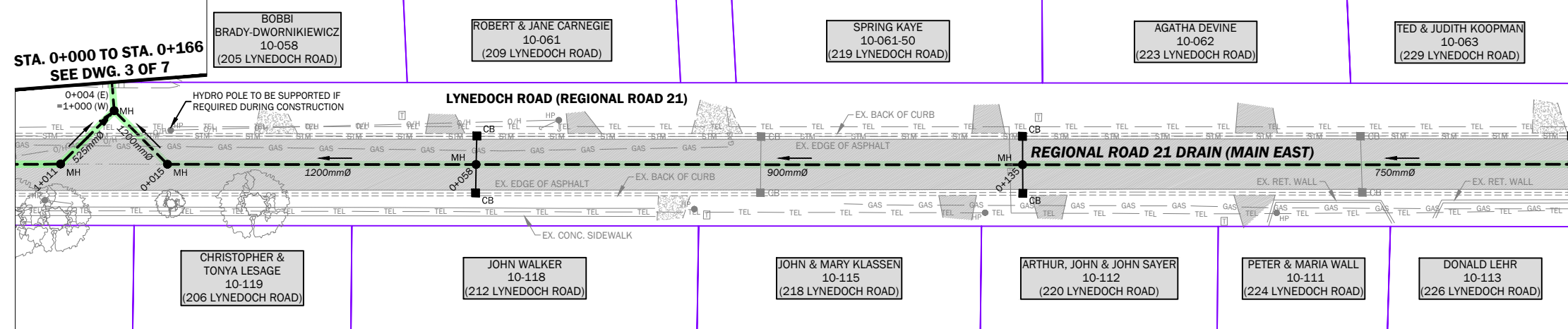

SCHEDULE OF PIPE MATERIALS

MATERIAL	DIAMETER (mm)	STATION RANGE	LENGTH (m)
1. HIGH DENSITY POLYETHYLENE PIPE	1200	0+000 - 0+004	4
2. REINFORCED CONCRETE PIPE	1200	0+004 - 0+058	54
3. REINFORCED CONCRETE PIPE	900	0+058 - 0+135	77
4. REINFORCED CONCRETE PIPE	750	0+135 - 0+212	77

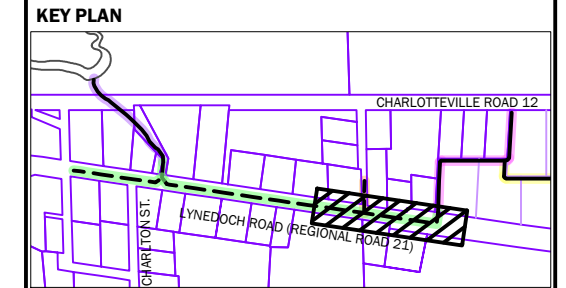
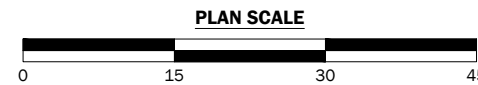
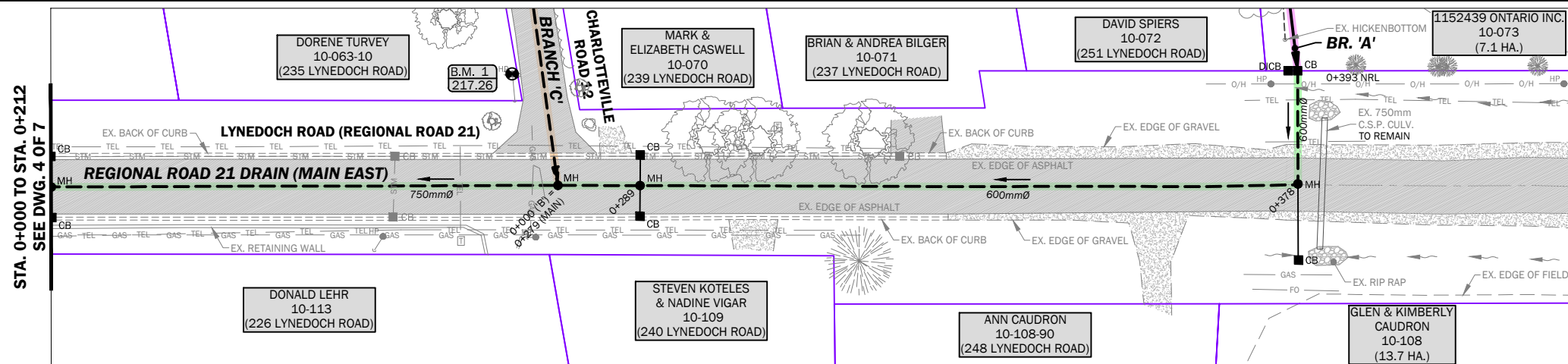

NOTES:
1. TOPOGRAPHIC SURVEY DATA WAS COLLECTED AND PROVIDED BY DIETRICH ENGINEERING LIMITED.

BENCHMARK DESCRIPTIONS
BENCHMARK No. 1 ELEV.=217.26
NAIL IN NORTHWEST FACE OF HYDRO POLE.

LEGEND

	LOT/CONCESSION LINE
	PROPERTY LINE
	FUTURE PROPERTY LINE
	BENCHMARK LOCATION
	BENCHMARK No.
	BENCHMARK ELEVATION
	LANDOWNER NAME(S)
	ASSESSMENT ROLL No. (ABBREVIATED)
	AREA WITHIN WATERSHED

EXISTING FEATURES:

	STORM SEWER WITH CATCH BASIN
	TELEPHONE LINE
	FIBER OPTIC LINE
	GAS LINE
	OVERHEAD UTILITY LINE
	HYDRO POLE WITH GUY WIRE
	TELEPHONE PEDESTAL

PROPOSED FEATURES:

	OPEN DRAIN WITH CROSSING AND FLOW DIRECTION
	CLOSED DRAIN WITH CATCH BASIN, MANHOLE AND FLOW DIRECTION

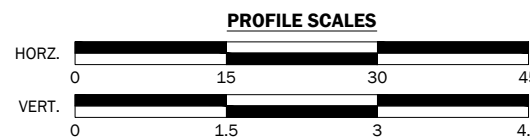
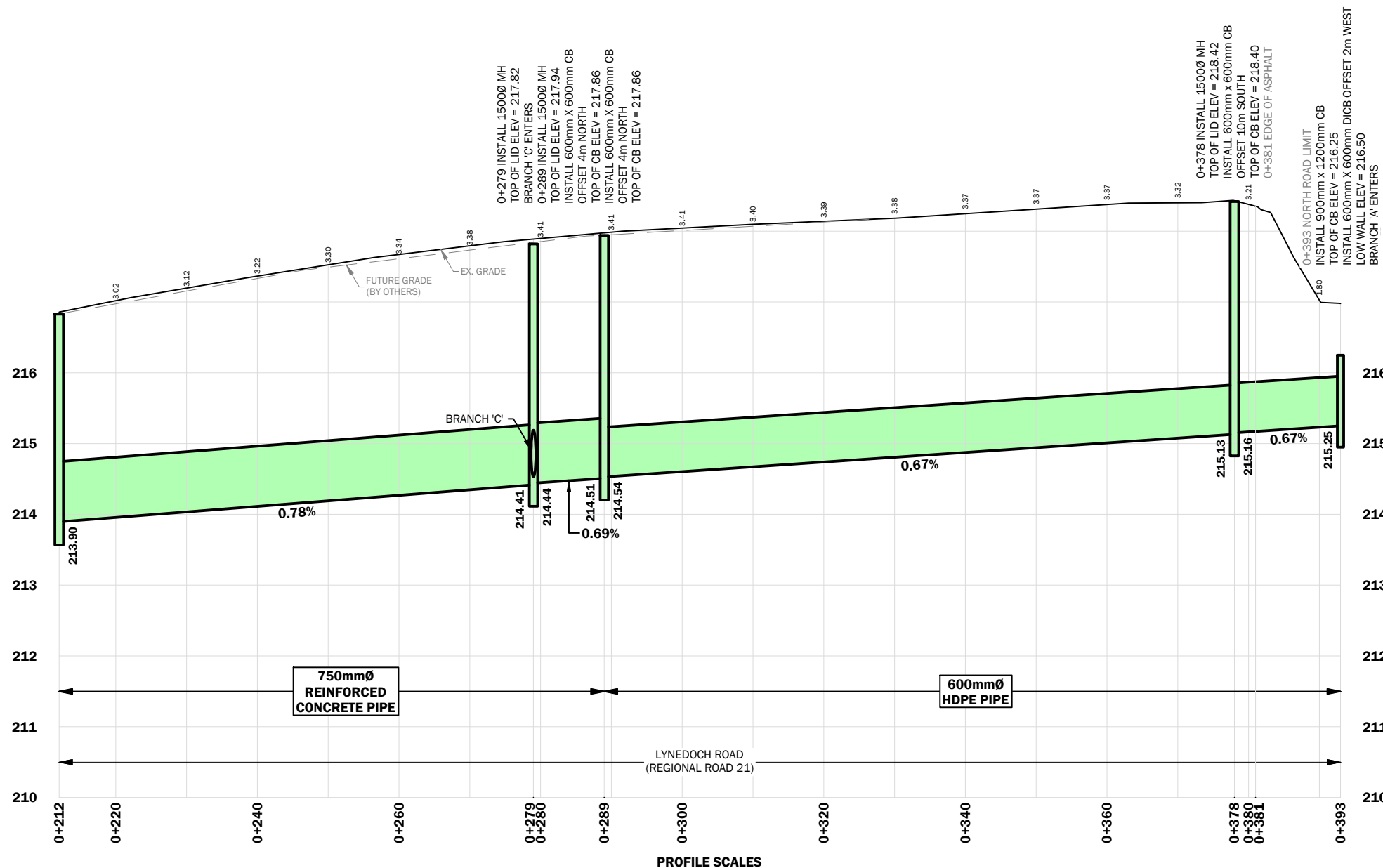

SCHEDULE OF PIPE MATERIALS

MATERIAL	DIAMETER (mm)	STATION RANGE	LENGTH (m)
1. REINFORCED CONCRETE PIPE	750	0+212 - 0+289	77
2. HIGH DENSITY POLYETHYLENE PIPE	600	0+289 - 0+393	104

8	ISSUED FOR CONSTRUCTION	23-07-04
7	ISSUED FOR TENDER	23-04-18
6	REPORT SUBMISSION	22-12-21
5	DRAFT REPORT SUBMISSION	SEP. 2022
4	INFORMATION MEETING	22-03-09
3	COUNTY MEETING	22-01-18
2	COUNTY MEETING	21-08-12
1	COUNTY SUBMISSION	21-05-11
No.	REVISION	DATE (YY-MM-DD)



DRAWN BY: R.U.	DESIGNED BY: S.B.	CHECKED BY: S.B.
DATE: 2023-04-18	REFERENCE No. NRFLK-001	DRAWING No. 6 OF 9

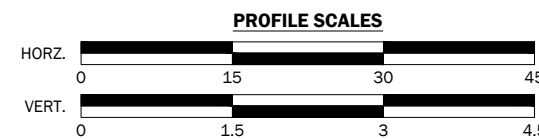
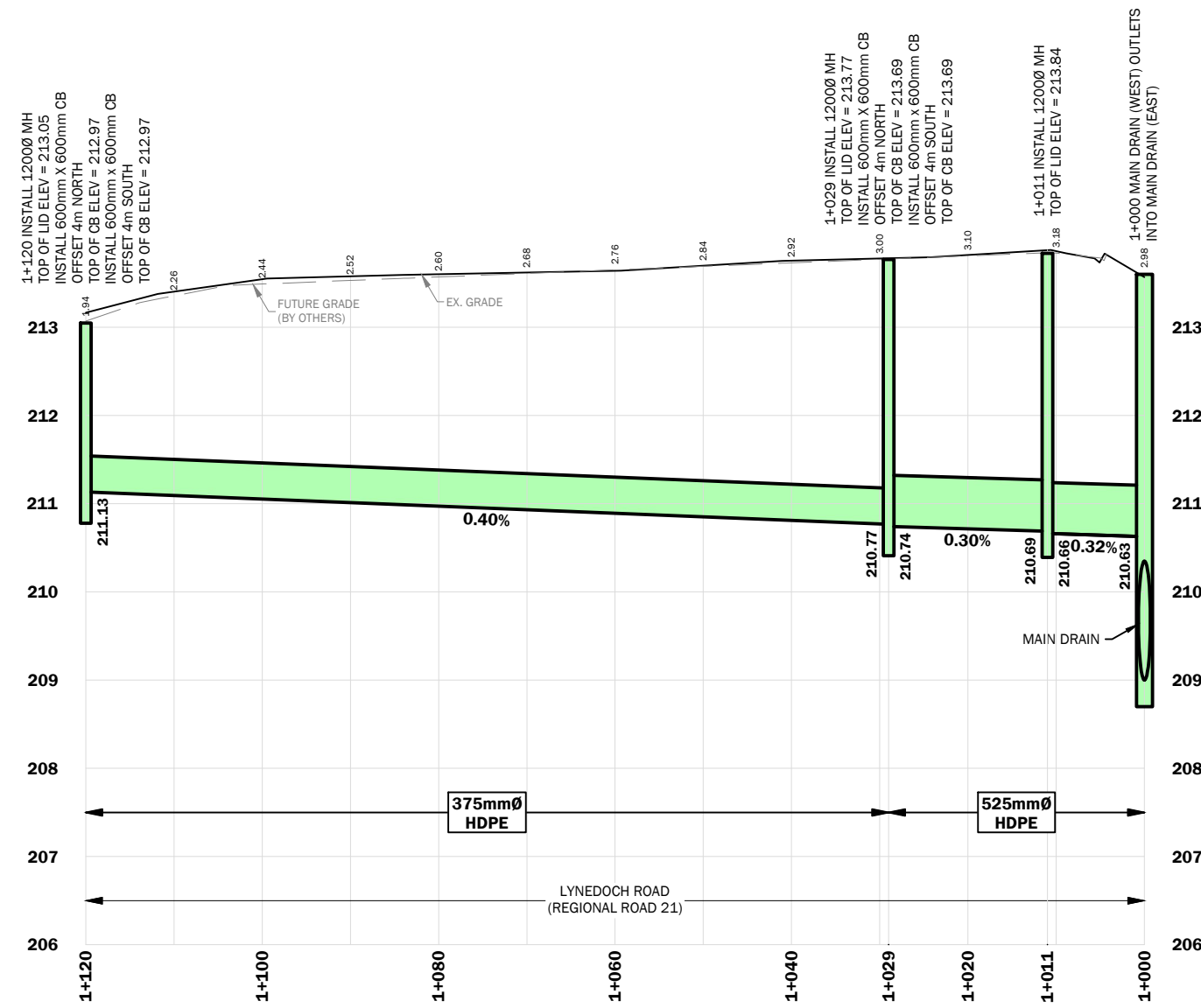
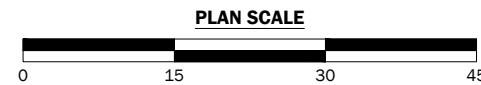
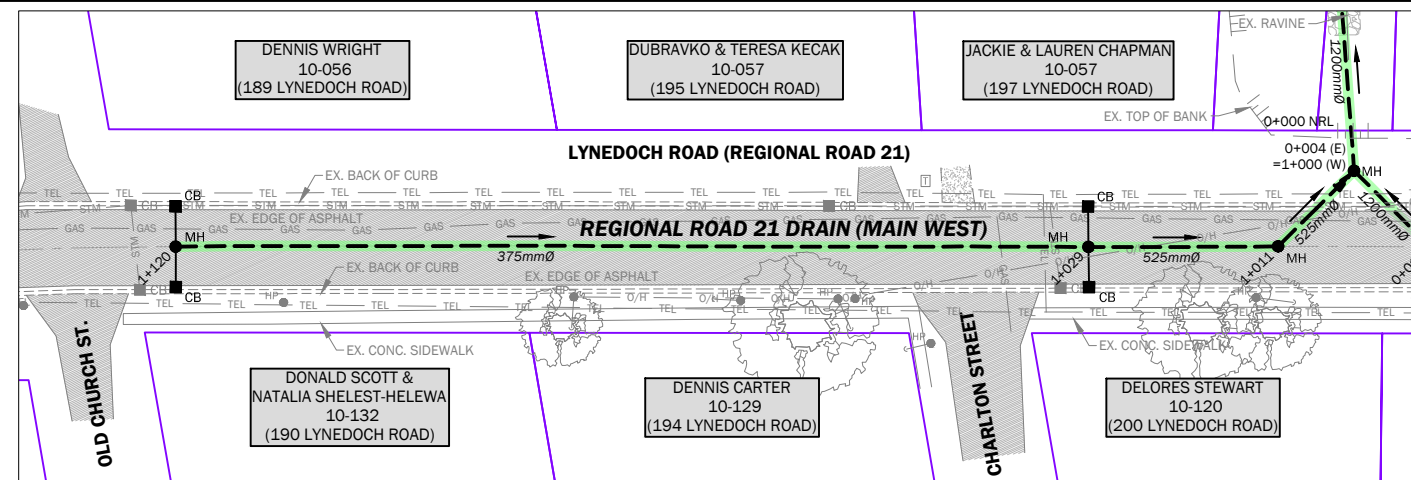

SCHEDULE OF PIPE MATERIALS

MATERIAL	DIAMETER (mm)	STATION RANGE	LENGTH (m)
1. HIGH DENSITY POLYETHYLENE PIPE	525	1+000 - 1+029	29
2. HIGH DENSITY POLYETHYLENE PIPE	375	1+029 - 1+120	91

KEY PLAN

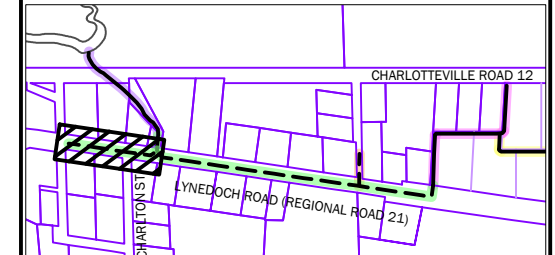

NOTES:

1. TOPOGRAPHIC SURVEY DATA WAS COLLECTED AND PROVIDED BY DIETRICH ENGINEERING LIMITED.

BENCHMARK DESCRIPTIONS

BENCHMARK No. 1 ELEV.=217.26
NAIL IN NORTHWEST FACE OF HYDRO POLE.

LEGEND

- LOT/CONCESSION LINE
- PROPERTY LINE
- FUTURE PROPERTY LINE
- BENCHMARK LOCATION
- B.M. 1 (123.45) BENCHMARK No. BENCHMARK ELEVATION
- JOHN & JANE SMITH (12-345 (12.3 Ha.)) LANDOWNER NAME(S) ASSESSMENT ROLL No. (ABBREVIATED) AREA WITHIN WATERSHED
- EXISTING FEATURES:
 - STM STM STORM SEWER WITH CATCH BASIN
 - TEL TEL TELEPHONE LINE
 - FO FO FIBER OPTIC LINE
 - GAS GAS GAS LINE
 - O/H O/H OVERHEAD UTILITY LINE
 - O.H.P. HYDRO POLE WITH GUY WIRE
 - TEL TELEPHONE PEDESTAL
- PROPOSED FEATURES:
 - DRAIN NAME CLOSED DRAIN WITH CATCH BASIN, MANHOLE AND FLOW DIRECTION

8	ISSUED FOR CONSTRUCTION	23-07-04
7	ISSUED FOR TENDER	23-04-18
6	REPORT SUBMISSION	22-12-21
5	DRAFT REPORT SUBMISSION	SEP. 2022
4	INFORMATION MEETING	22-03-09
3	COUNTY MEETING	22-01-18
2	COUNTY MEETING	21-08-12
1	COUNTY SUBMISSION	21-05-11
No.	REVISION	DATE (YY-MM-DD)



DRAWN BY: R.U.	DESIGNED BY: S.B.	CHECKED BY: S.B.
DATE: 2023-04-18	REFERENCE No. NRFLK-001	DRAWING No. 7 OF 9

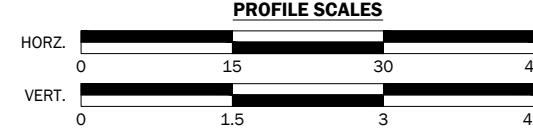
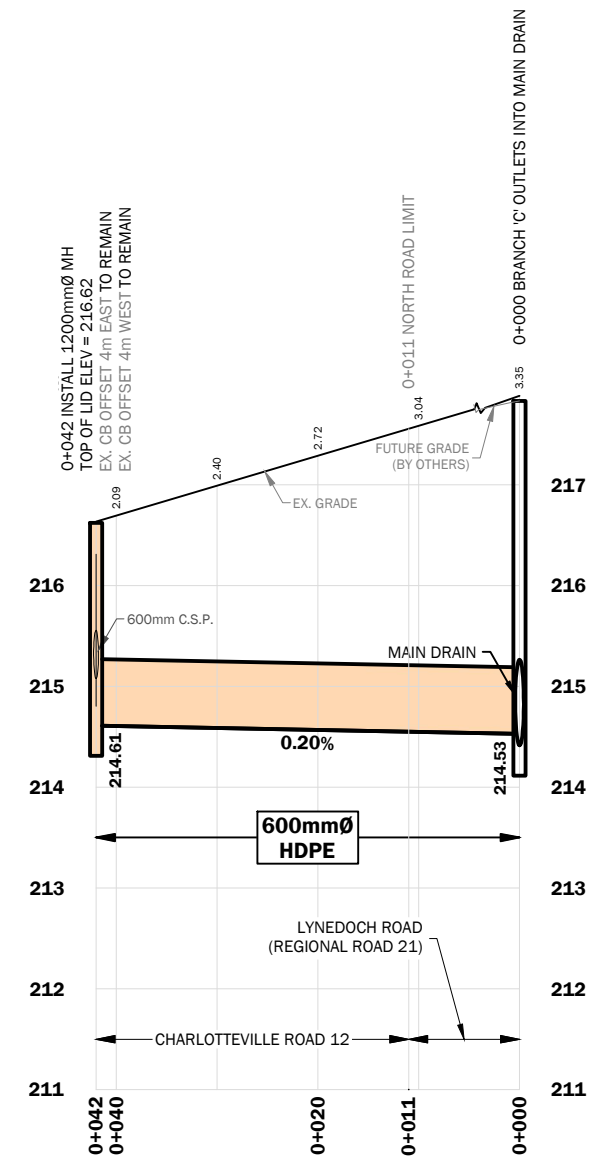
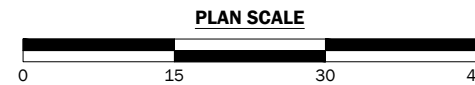
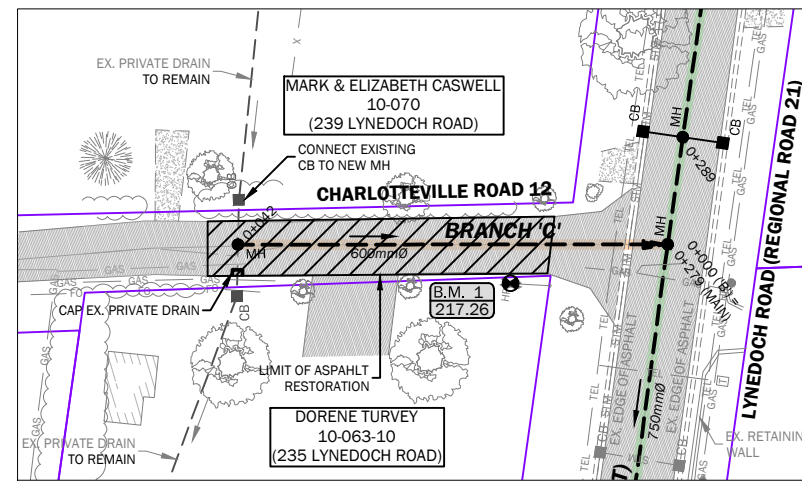

SCHEDULE OF PIPE MATERIALS

MATERIAL	DIAMETER (mm)	STATION RANGE	LENGTH (m)
1. HIGH DENSITY POLYETHYLENE PIPE	600	0+000 - 0+042	42

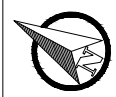

KEY PLAN

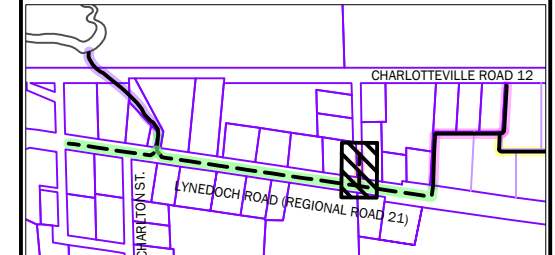

NOTES:

- TOPOGRAPHIC SURVEY DATA WAS COLLECTED AND PROVIDED BY DIETRICH ENGINEERING LIMITED.

BENCHMARK DESCRIPTIONS

BENCHMARK No. 1 ELEV.=217.26
NAIL IN NORTHWEST FACE OF HYDRO POLE.

LEGEND

- LOT/CONCESSION LINE
 - PROPERTY LINE
 - FUTURE PROPERTY LINE
 - BUILDING
 - FENCE
 - BENCHMARK LOCATION
 - B.M. 1 123.45 BENCHMARK No. BENCHMARK ELEVATION
 - JOHN & JANE SMITH 12-345 (12.3 Ha.) LANDOWNER NAME(S) ASSESSMENT ROLL No. (ABBREVIATED) AREA WITHIN WATERSHED
- EXISTING FEATURES:
- STM STORM SEWER WITH CATCH BASIN
 - TEL TELEPHONE LINE
 - FO FIBER OPTIC LINE
 - GAS GAS LINE
 - O/H OVERHEAD UTILITY LINE
 - O.H.P. HYDRO POLE WITH GUY WIRE
 - TEL TELEPHONE PEDESTAL
- PROPOSED FEATURES:
- DRAIN NAME CLOSED DRAIN WITH CATCH BASIN, MANHOLE AND FLOW DIRECTION

8	ISSUED FOR CONSTRUCTION	23-07-04
7	ISSUED FOR TENDER	23-04-18
6	REPORT SUBMISSION	22-12-21
5	DRAFT REPORT SUBMISSION	SEP. 2022
4	INFORMATION MEETING	22-03-09
3	COUNTY MEETING	22-01-18
2	COUNTY MEETING	21-08-12
1	COUNTY SUBMISSION	21-05-11
No.	REVISION	DATE (YY-MM-DD)



DRAWN BY: R.U.	DESIGNED BY: S.B.	CHECKED BY: S.B.
DATE: 2023-04-18	REFERENCE No. NRFLK-001	DRAWING No. 8 OF 9

BENCHMARK DESCRIPTIONS

BENCHMARK No. 1 ELEV.=217.26
NAIL IN NORTHWEST FACE OF HYDRO POLE.

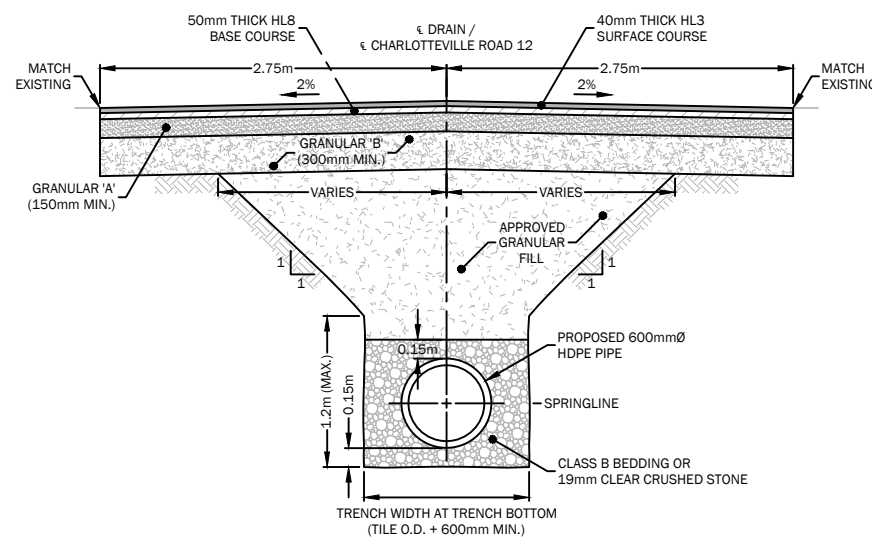
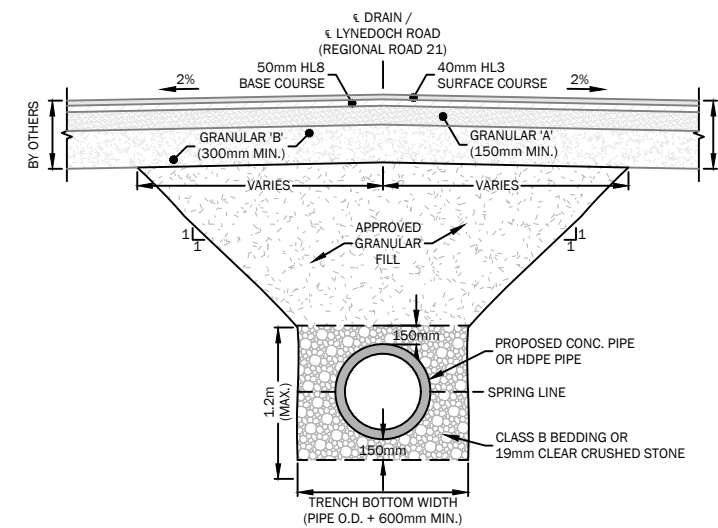
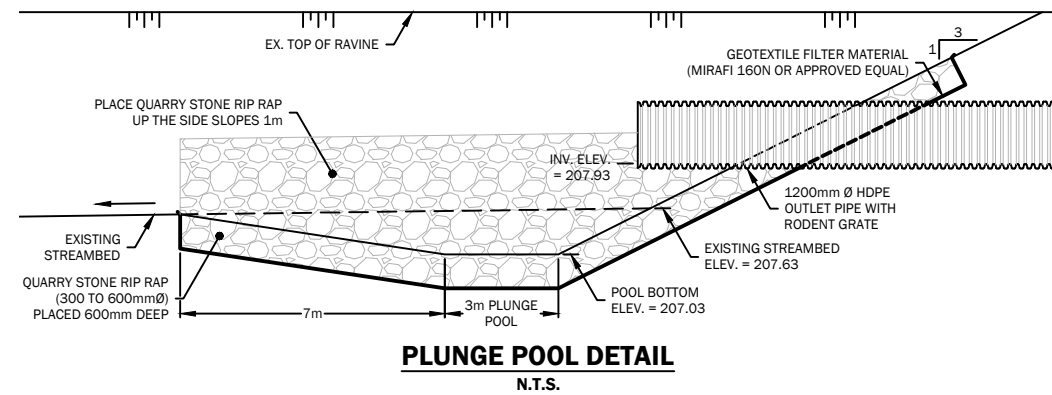

NOTES:

1. THE HOT MIX ASPHALT SURFACE COURSE TO BE PLACED IN A 50mm LIFT, OTHER BINDER COURSE LIFT THICKNESS NOT TO EXCEED 80mm.
2. WHERE EXISTING HOT MIX ASPHALT DEPTH IS BETWEEN 80mm AND 120mm, A 40mm STEP JOINT IS REQUIRED. A STEP JOINT IS NOT REQUIRED FOR ASPHALT DEPTHS LESS THAN 80mm.

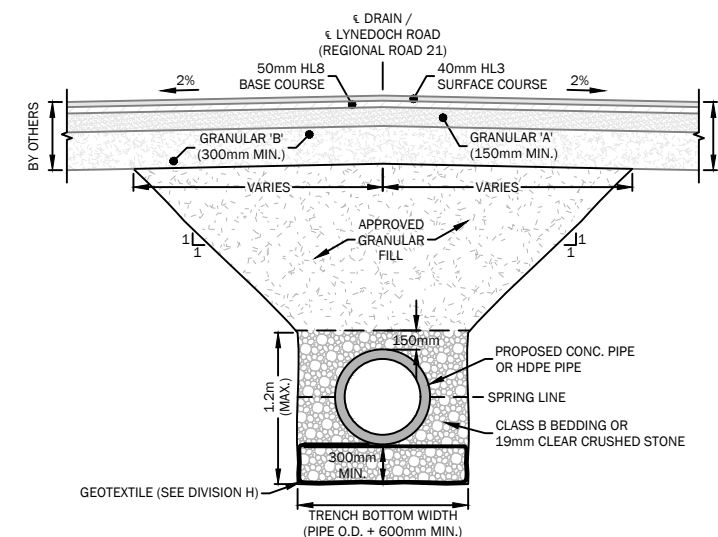

8	ISSUED FOR CONSTRUCTION	23-07-04
7	ISSUED FOR TENDER	23-04-18
6	REPORT SUBMISSION	22-12-21
5	DRAFT REPORT SUBMISSION	SEP. 2022
4	INFORMATION MEETING	22-03-09
3	COUNTY MEETING	22-01-18
2	COUNTY MEETING	21-08-12
1	COUNTY SUBMISSION	21-05-11
No.	REVISION	DATE (YY-MM-DD)



DRAWN BY: R.U.	DESIGNED BY: S.B.	CHECKED BY: S.B.
DATE: 2023-04-18	REFERENCE No. NRFLK-001	DRAWING No. 9 OF 9